

PHYSICAL CHARACTERISTICS
RJ45 INSERTION LIFE: 750 MATING CYCLES WITH FCC COMPLIANT 8P PLUG.
OPERATING TEMPERATURE RANGE : -10°C ~ 60 °C.
STORAGE TEMPERATURE RANGE: -40 °C ~ 68 °C.
HUMIDITY : 10% ~ 90% RH (NON-CONDENSING).

ELECTRICAL
INSULATION RESISTANCE : 100 MΩ MIN.
DC CURRENT RATING : 1.5 Amps.
RJ45 INPUT TO OUTPUT D.C. RESISTANC: 100 mΩ MAX.
CONTACT RESISTANCE : 15 mΩ MAX.
VOLTAGE PROOF (CONTACT TO CONTACT): 500 V AC.
VOLTAGE PROOF (CONTACT TO SHIELD): 500 V DC.

NOTE
• ONLY ACCEPT RJ-45 8P8C PLUG.

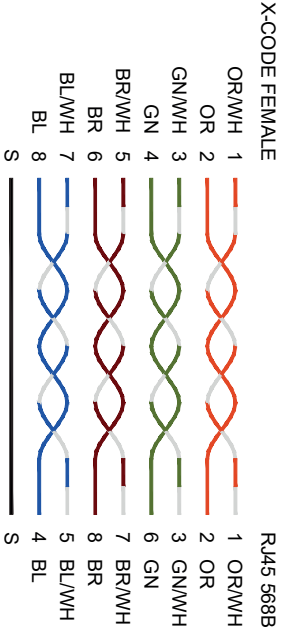
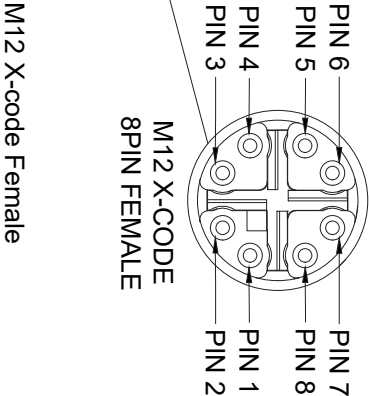
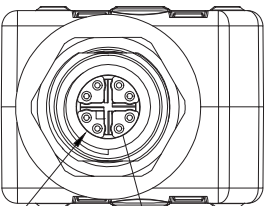
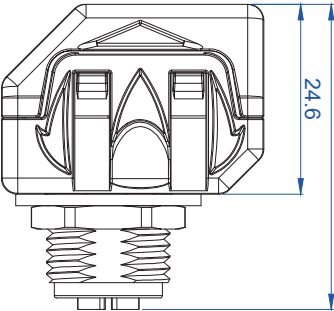
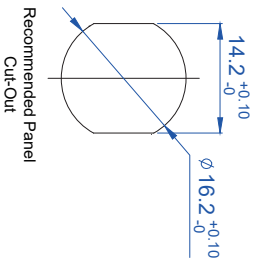
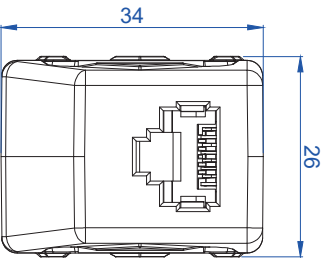
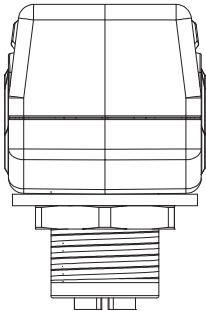

MATERIAL			
BRACKET	NICKEL SILVER ALLOY	M12 INSULATOR	THERMOSETTING POLYMER
ADAPTER HOUSING	ZINC ALLOY, NICKEL PLATED	M12 SHELL	COPPER ALLOY, NICKEL PLATED
RJ45 CONTACTS	PHOSPHOR BRONZE, 50U" GOLD PAINTING	M12 DIE CASTING	ZINC ALLOY, NICKEL PLATED
M12 METAL PARTS	COPPER ALLOY, 30U" GOLD PAINTING		

Dat	2024 / 05 / 22	<div>DLOCK® we move the world</div> <div>Title: M12 Adapter X-coded 8 pin female to RJ45 jack Cat.6A STP metal</div>	
Unit	mm		
Projection			
Rev	A		
Item no.		Barcode	4043619606856
File No.			88469

60685